

AVOLUX®
PROFESSIONAL LIGHTING CENTER

» Horticulture LED Lighting
Technology

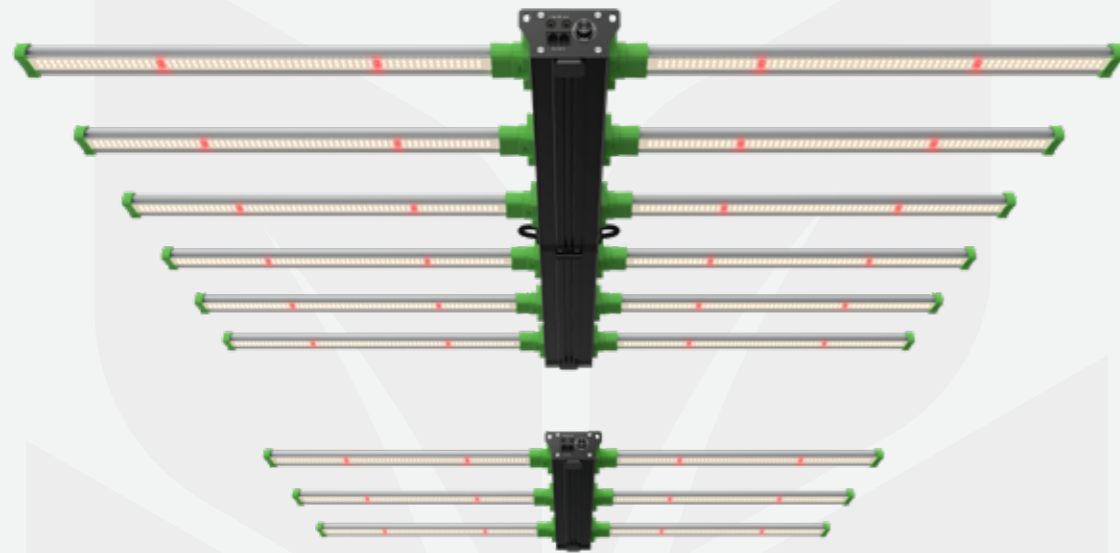

New optimal solution for distribution and wholesale. Slim profile passive cooled design gives it better heat dissipation. The Transformer design of the horticultural lighting market, flexible DIY style, is more popular in the home grown market.



Key Features

- The smallest volume weight in the industry
- Internal driver with DIY detachable light bars can simply install without any tools assembling, and also easy to maintain the light modules.
- The combination of built-in power supply and detachable light bars reduces the package size and is suitable for distribution and wholesale.



DIY



0-10V Dimming



Product Dimensions

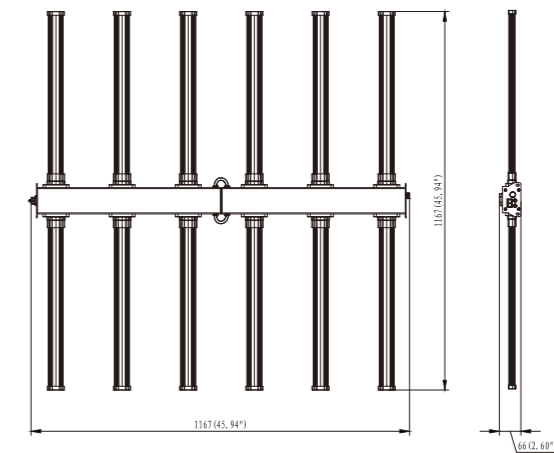
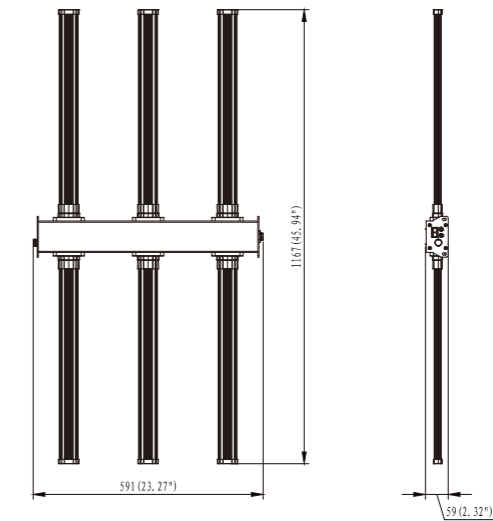

Product Specifications

System Efficacy

2.3 $\mu\text{mol}/\text{J}$

Dimming

0~10 V Dimming

Warranty

5 Years Warranty

Certificate

ETL, CE, RoHs

Item No	HL33-320	HL33-640
Power	320 W	640 W
PAR Output	752 $\mu\text{mol}/\text{s}$	1472 $\mu\text{mol}/\text{s}$
ePAR Output	767 $\mu\text{mol}/\text{s}$	1501 $\mu\text{mol}/\text{s}$
AC Input Voltage	100-240 V AC / 100-277 V AC, 50/60 Hz	
Radiation Angle	120°	
Net Weight	4.3 kg / 9.5 lbs	9.2 kg / 20.3 lbs
Gross Weight	6.0 kg / 13.2 lbs	11.4 kg / 25.1 lbs
Dimensions	1167 x 591 x 59 mm (45.94" x 23.27" x 2.32")	1167 x 1167 x 66 mm (45.94" x 45.94" x 2.60")

Accessories



Ratchet Hanger Pulley Rope



M19 AC Plug

Spectrum Solution

This enhanced full spectrum produces the fastest flowering for plant species grown indoors under artificial lighting. The spectrum most closely mimics the sun and can meet the needs of both high and low DLI crops.

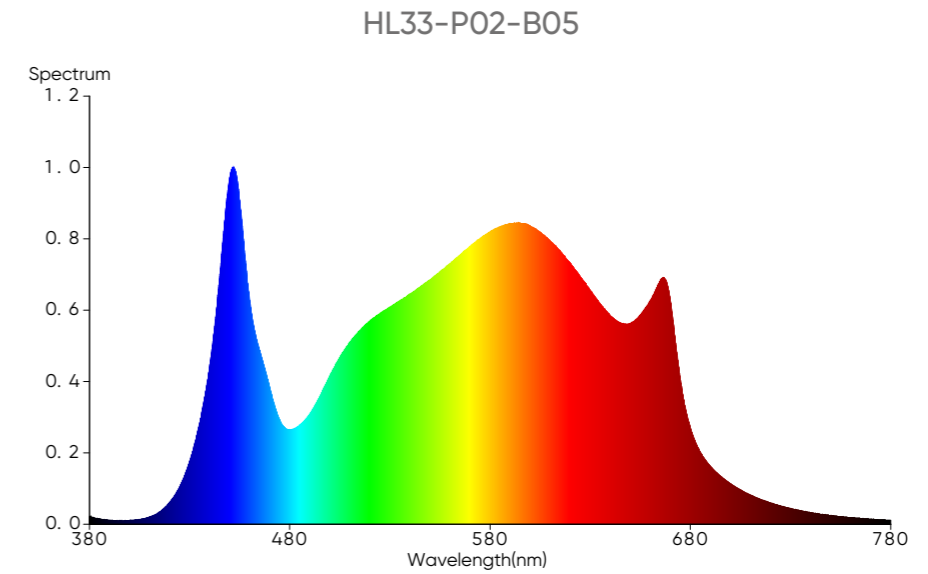

Full-cycle top lighting solution for cannabis plants, the simplicity of installation and use make it an ideal solution for achieving high and uniform lighting levels in greenhouse and indoor sole-source applications.

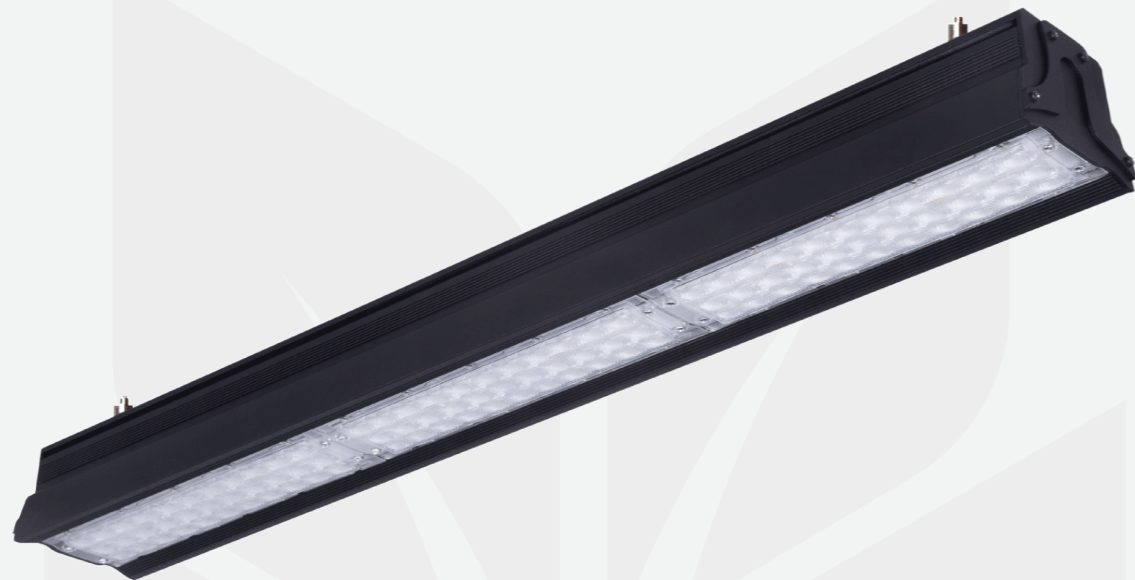

Key Features

- Designed with tempered glass cover, resistant to all kinds of corrosion from nutrient solutions and pesticide, and resistant to high-pressure water jet cleaning.
- Compact design, can minimize shadow effect.
- No additional assembly is required as the fixture is ready for installation and intended use.



Resistant water jet

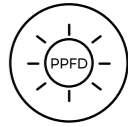

High PPFD



Product Dimensions

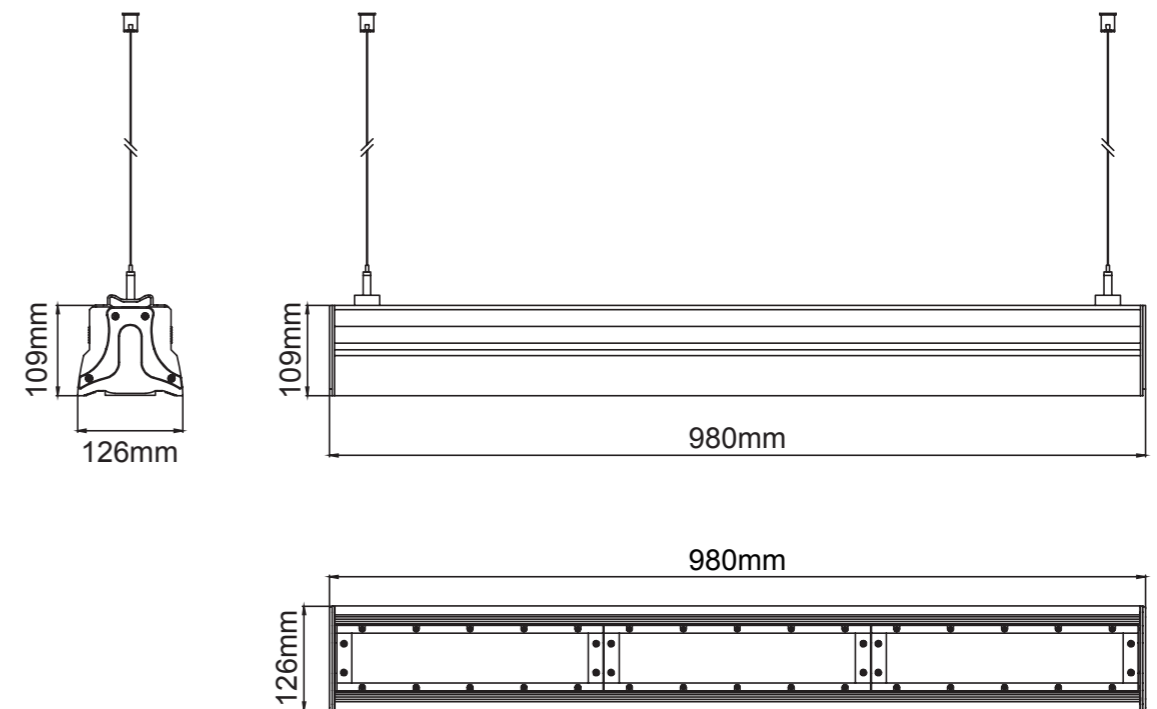

Product Specifications

System Efficacy

2.0 $\mu\text{mol}/\text{J}$, 2.8 $\mu\text{mol}/\text{J}$

Dimming

0~10 V Dimming

IP Rating

IP65

Warranty

5 Years Warranty

Certificate

ETL, CE, RoHs

Item No	HL06-600
Power	600 W
PAR Output	1148 $\mu\text{mol}/\text{s}$ 1806 $\mu\text{mol}/\text{s}$
ePAR Output	1200 $\mu\text{mol}/\text{s}$ 1806 $\mu\text{mol}/\text{s}$
AC Input Voltage	100-240 V AC / 100-277 V AC / 277-480 V AC, 50/60 Hz
Radiation Angle	120°
Net Weight	11.6 kg / 25.7 lbs
Gross Weight	12.68 kg / 27.95 lbs
Dimensions	1177 x 145 x 136 mm (46.34" x 5.7" x 5.35")

Accessories



Ratchet Hanger Pulley Rope

Spectrum Solution

At the flowering stage of cannabis, using full spectrum flowering distribution promotes nutrient growth of cannabis plants, designed with an emphasis on the red and far red range to ensure the quality and quantity of flowering yields. With a peak wavelength of 400nm is designed to provide beneficial photomorphogenic responses by creating a mild stress response in plants. Research shows increased THC content in cannabis plants.

HL06-P17-00

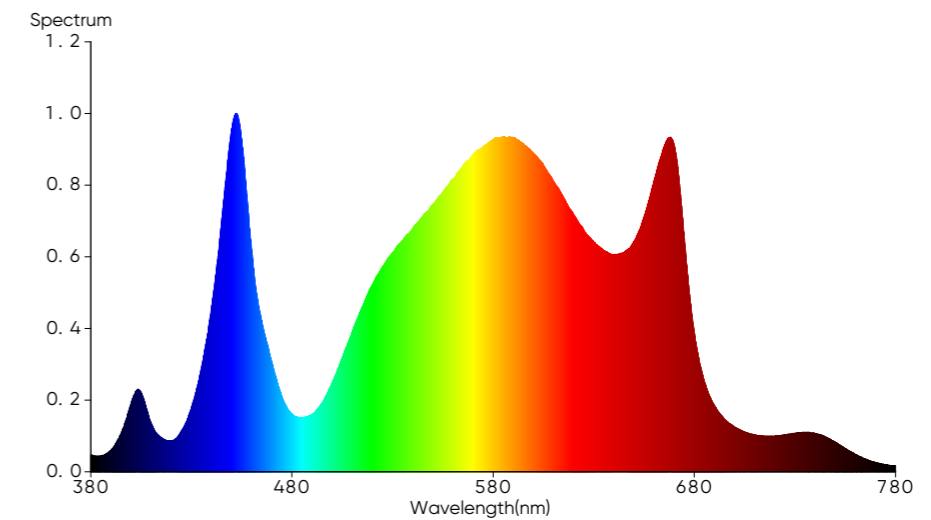

HL06-P06-B00 offers photon emission across the PAR 400-700nm continuous wavelength range, mixing white, red and blue to get energy efficiency with quality of light for desired plant response.

HL06-P06-B00

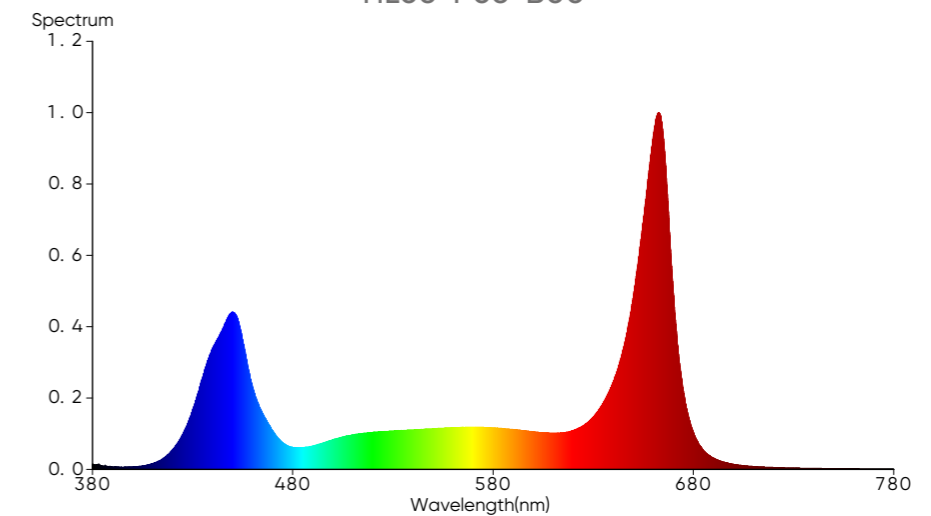

Greenhouse supplemental intercanopy light, being angled with respect to the horizontal, that 120° light is only accessible at the highest part of the crop because of the density of the leaves of the plant. Intercanopy lighting spreads the light more evenly over the canopy and in the middle part of the crop which increases flower development.

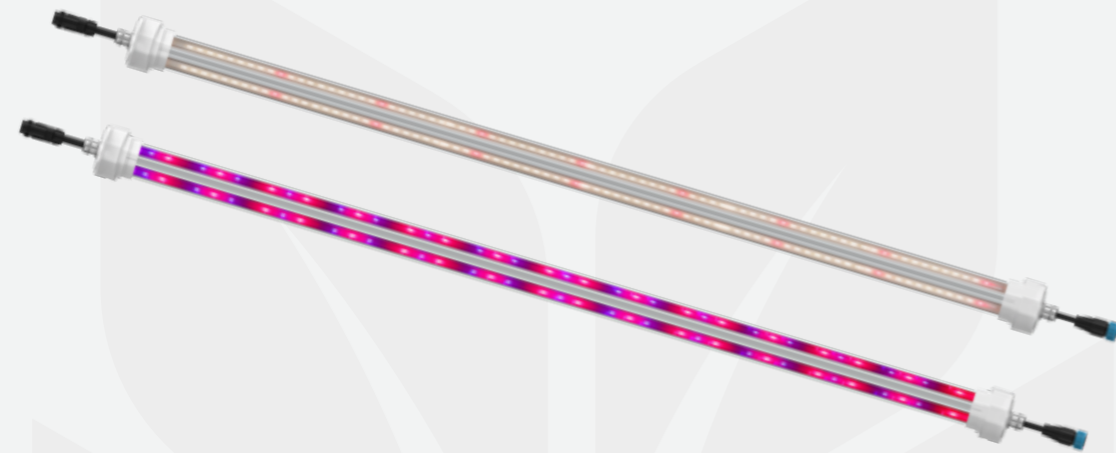

Key Features

- Daisy chain design helps save installation time and reduce total installation cost in commercial projects.
- IP65 rated makes LED intercanopy operate well in greenhouse, indoor or other high humidity environments.
- Double-sided lighting design, minimizes light interception and keeps the lower canopy to get optimal and uniform light.
- Inverted triangle structure minimizes the shadow on the plant canopy which is caused by the light from the top.

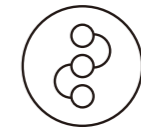

Daisy chain



IP65



Product Dimensions

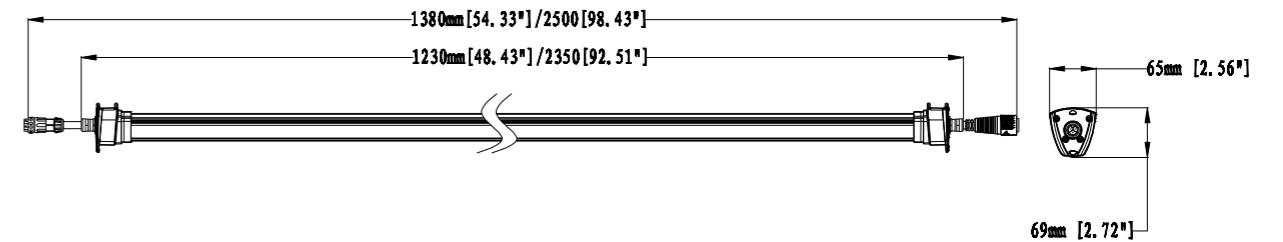

Product Specifications

System Efficacy

2.34 $\mu\text{mol}/\text{J}$, 3.0 $\mu\text{mol}/\text{J}$

Dimming

0~10 V Dimming

IP Rating

IP65

Warranty

5 Years Warranty

Certificate

ETL, CE, RoHs

Item No	HL03-75	HL03-150
Power	75 W	150 W
PAR Output	176 $\mu\text{mol}/\text{s}$ 225 $\mu\text{mol}/\text{s}$	351 $\mu\text{mol}/\text{s}$ 450 $\mu\text{mol}/\text{s}$
ePAR Output	194 $\mu\text{mol}/\text{s}$ 226 $\mu\text{mol}/\text{s}$	387 $\mu\text{mol}/\text{s}$ 452 $\mu\text{mol}/\text{s}$
AC Input Voltage	100-240 V AC / 100-277 V AC / 277-480 V AC, 50/60 Hz	
Radiation Angle	120°	
Net Weight	1.5 kg / 3.3 lbs	2.5 kg / 5.5 lbs
Gross Weight	7.0 kg / 15.4 lbs	12.0 kg / 26.5 lbs
	4 pcs per carton	
Dimensions	1380 x 65 x 69 mm (54.33" x 2.56" x 2.72")	2500 x 65 x 69 mm (98.43" x 2.56" x 2.72")

Accessories



External Driver



Ratchet Hanger Pulley Rope



M19 AC Cable

Spectrum Solution

450nm blue light plays an important role in the early stage of plant growth and helps to establish a developed root system. With a peak wavelength of 730nm is designed to boost photosynthetic light levels in flowering stage, far red light will create a competitive response in plants, assisting in the formation of trichomes.

HL03-P04-00

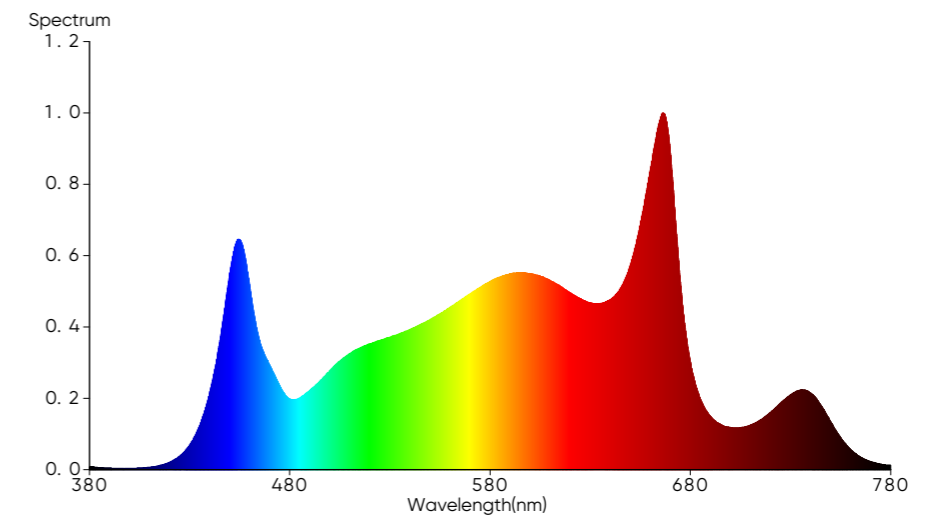

HL03-P03-00 features two narrow spectral wavelength that maximize energy efficiency, aiming to further reduce energy cost and operational expense.

HL03-P03-00

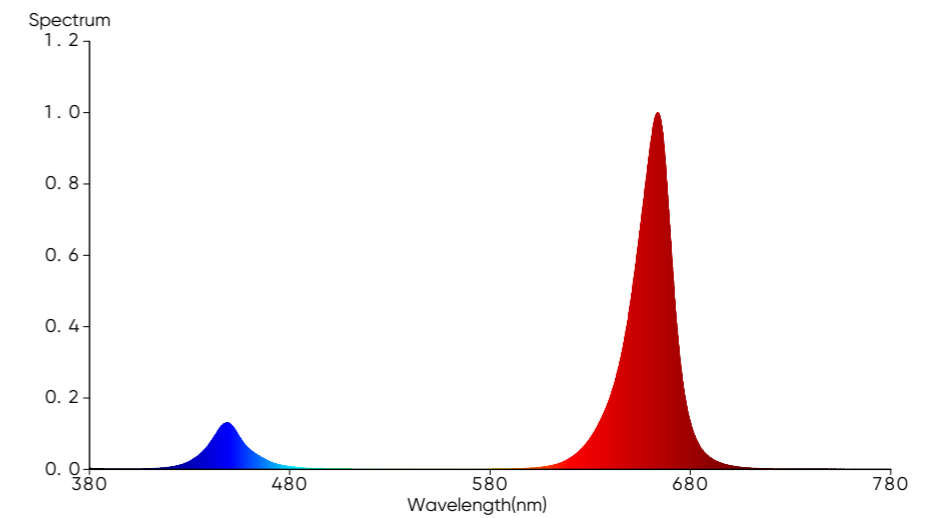

Designed for growth rooms and chambers, tissue culture and vertical farming applications. With excellent light uniformity when placed right above the canopy, it is ideal for vertical farming.



Key Features

- Daisy chain solution
- True sunlight spectrum
- Excellent heat dissipation performance

External driver, good for reliable and maintainable performance



PC cover



IP65



Product Dimensions

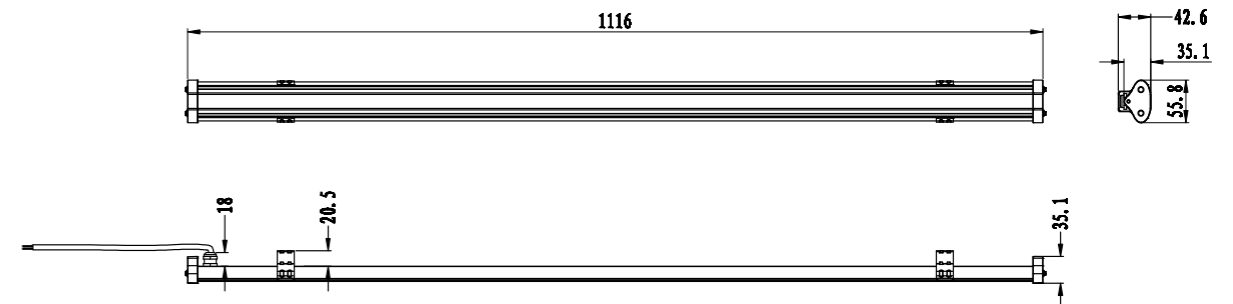

Product Specifications

System Efficacy

1.55 $\mu\text{mol}/\text{J}$

Dimming

0~10 V Dimming

IP Rating

IP65

Warranty

5 Years Warranty

Certificate

ETL, CE, RoHs

Item No	HL05-40	HL05-75	HL05-90
Power	40 W	75 W	90 W
PAR Output	62 $\mu\text{mol}/\text{s}$	116 $\mu\text{mol}/\text{s}$	140 $\mu\text{mol}/\text{s}$
ePAR Output	67 $\mu\text{mol}/\text{s}$	122 $\mu\text{mol}/\text{s}$	148 $\mu\text{mol}/\text{s}$
AC Input Voltage	100-240 V AC / 100-277 V AC, 50/60 Hz		
Radiation Angle	120°		
Net Weight	0.8 kg / 1.8 lbs		
Gross Weight	6.4 kg / 14 lbs 8 pcs per carton		
Dimensions	1116 x 55.8 x 35.1 mm (43.9" x 2.2" x 1.4")		

Accessories



Standard:
High Ceiling Mounting Bracket



Optional:
Low Ceiling Mounting Bracket



External Driver



Splitter Cable

Spectrum Solution

A balanced range of wavelengths from UV to FR suitable for all growth stages. It has been tested on and is suitable for most plant species cultivated worldwide. SUNLIKE spectrum works as both sole source or supplemental light.

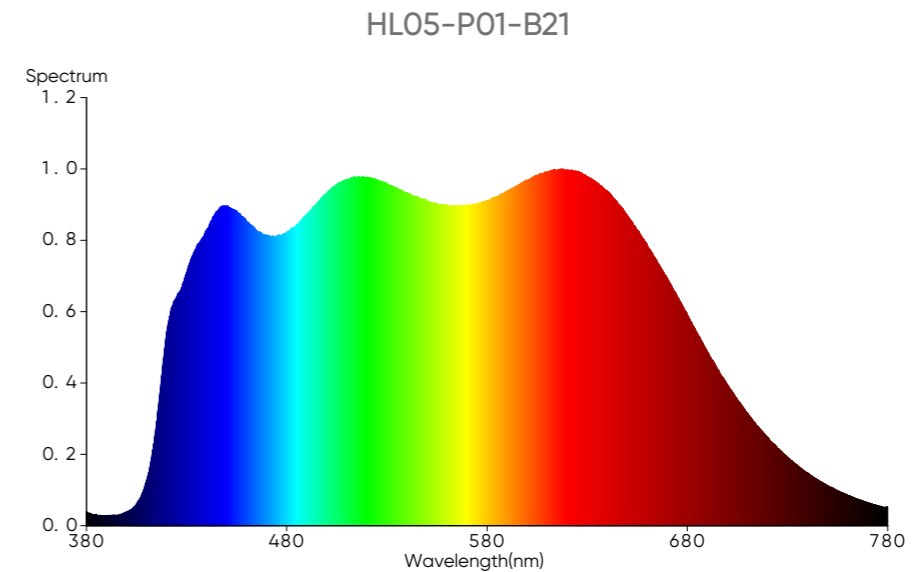

Complete replacement of florescent T5 fixtures or HPS/metal halide lights for inside vegging to grow moms, clones, or any starts in a completely controlled environment.

Key Features

- Simple and stylish, ultra slim design
- Linkable solution, save cable cost and installation cost, easy to connect light weight, easy maintenance in both transportation to meet your budget.



Product Dimensions

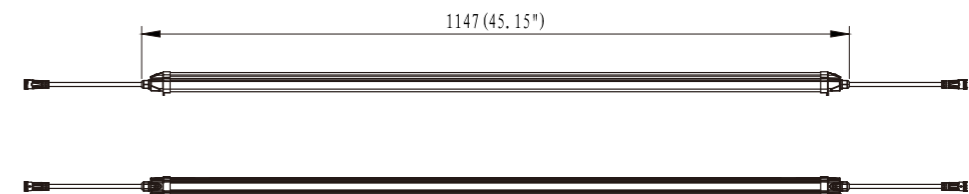
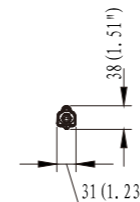

Product Specifications

System Efficacy

2.3 $\mu\text{mol}/\text{J}$

Dimming

No Dimming

Warranty

3 Years Warranty

IP Rating

IP65

Item No	CHL01-20
Power	20 W
PAR Output	46 $\mu\text{mol}/\text{s}$
ePAR Output	47 $\mu\text{mol}/\text{s}$
AC Input Voltage	100-240 V AC, 50/60 Hz
Radiation Angle	120°
Net Weight	0.28 kg / 0.62 lbs
Gross Weight	10.6 kg / 21.3 lbs 30 pcs per carton
Dimensions	1147 x 31 x 38 mm (45.2" x 1.2" x 1.5")

Accessories



Ceiling Bracket

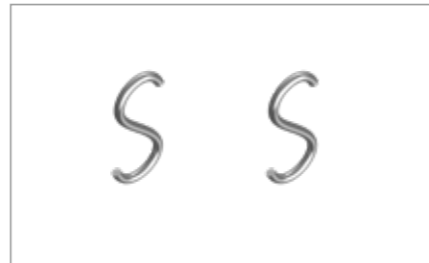

S Shaped Hook (optional)



AC Cord 1.5m with EU Plug



M15 Waterproof Cap

Spectrum Solution

The spectrum is based on cooler (blue spectrum) white light, making it ideal for the vegetative and cloning stages of plant growth. The spectrum comes very close to natural daylight, truly simulating what plants have adapted to over many generations. It is especially well suited for seedling.

CHL01-P01-00

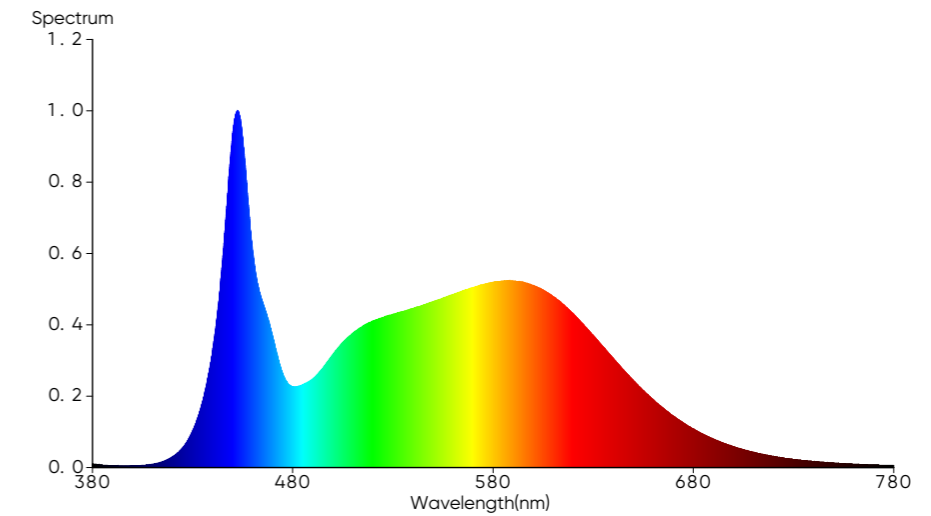

AVOLUX®

PROFESSIONAL LIGHTING CENTER

MURAT AYDINLATMA SAN. ve TIC. A.Ş

FOREIGN TRADE DEPARTMENT

Phone : +90 (212) 855 10 99

Fax : +90 (212) 855 57 64

email: sales@avolux.com

FACTORY - 1 Headquarter / FABRİKA - 1 Merkez

Ömerli Mah. Rengin Sok. No:13

Hadımköy - Arnavutköy / İstanbul - Türkiye

email: satis@avolux.com

FACTORY - 2 / FABRİKA - 2

Velimese OSB Mah. 242.Sok. 4/1

Ergene / Tekirdag - Türkiye

email: satis@avolux.com

FABRİKA SATIŞ DEPARTMANI

Tel : +90 (212) 855 40 60

: +90 (212) 855 99 96

Fax : +90 (212) 855 57 64

www.avolux.com

e-mail: info@avolux.com